

Barcode Setup

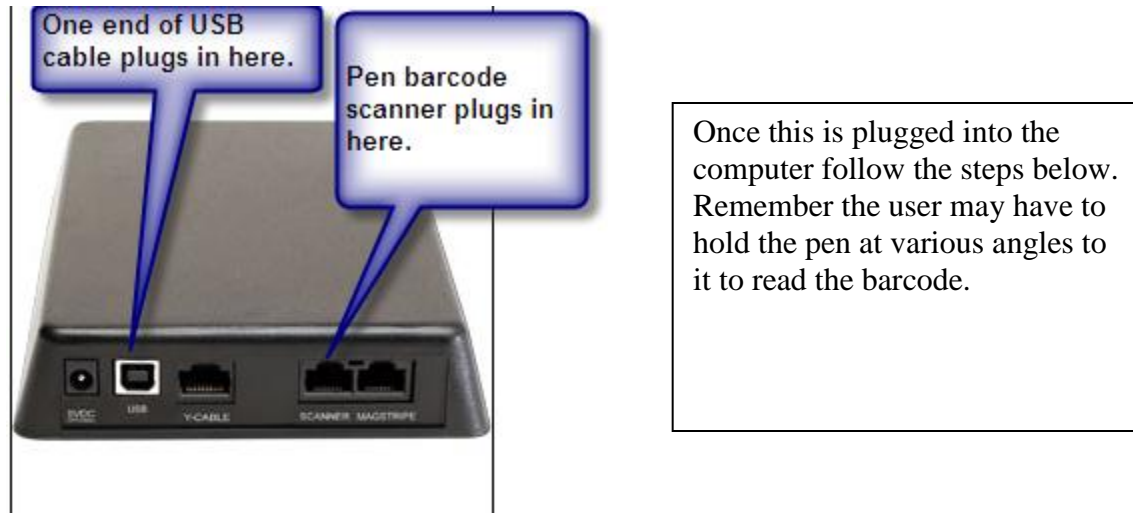

Client needs the laminated WDP Reader Setup Menu. If they do not have it they can print it to a laser / inkjet printer from the following web site. Note they will need acrobat reader in order to read this document.

Barcodehq.com/menus/uswdpset.pdf

After each swipe you should hear the barcode wand beep. If you do not hear the beep scan the barcode until it does.

1. Start Setup

2. 2 of 5 code

3. 0 (Barpad Table)

4. 2 of 5 code

5. 2 (Barpad Table)

6. 2of 5 length

7. 1 (Barpad Table)

8. 0 (Barpad Table)

9. Terminator Character

10. 1 (Barpad Table)

Steps 11 – 14 are not used anymore so you can skip these steps and go to step 15.
As of 2011.

11. Computer Interface

12. 1 (Barpad Table)

13. Data Transmission

14. 1 (Barpad Table)

15. End Setup